



# Flush-Fit™ Socket Head Drum Sprays

Type X  
Trim-Jet™

Steinen Mfg. Co. 29 East Halsey Road, Parsippany, NJ 07054 973.887.6400 F: 973.887.4632 info@steinen.com www.steinen.com

## TYPE "X" TRIM-JET™

Type "X" TRIM-JET™ flush fit spray nozzles produce a precision uniform full cone spray are generally used in Highwall and Longwall mining applications.

The Type "X" TRIM-JET™ nozzle is manufactured by HAHN Industries, a Division of Steinen.

- The Type X TRIM-JET™ is available in Brass or 303 Stainless Steel in 3/8" NPT male thread.

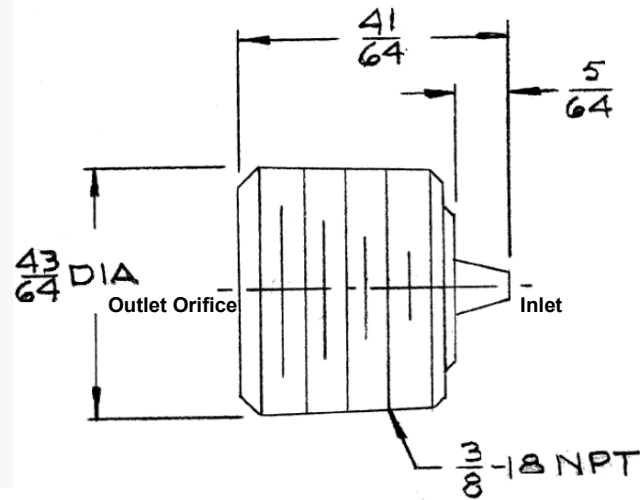

Nozzle Type	Steinen Part #	INLET		OUTLET ORIFICE		RATED CAPACITY (gallons/minute)					SPRAY ANGLE (approx.)
		Decimal	Fraction	Decimal	Fraction	20 PSI	40 PSI	60 PSI	80 PSI	100 PSI	
3/8" Type X TRIM JET™	270-20050	.063"	1/16"	0.08	5/64"	0.64	0.90	1.10	1.27	1.42	40°
	270-21050	.094"	3/32"	0.08	5/64"	1.10	1.25	1.53	1.77	1.98	45°

HAHN

