

TYPE "S" (Steinen/Hahn)

Type "S" full cone nozzles produce a uniform wide angle (120°) cone spray and are generally used in mining and other applications for dust suppression.

The **Type "S"** nozzle is manufactured by HAHN Industries, a Division of Steinen.

- The **Type "S"** nozzle is Steinen Part # 147-00043.
- Steinen has also sold this nozzle under Part # SN180-00-000-01.
- This nozzle is also manufactured for **Joy Mining (Joy Part # 01566237-0000)**.
- **All of the above part numbers are the same nozzle.**



Type "S" nozzle
Part # 147-00043

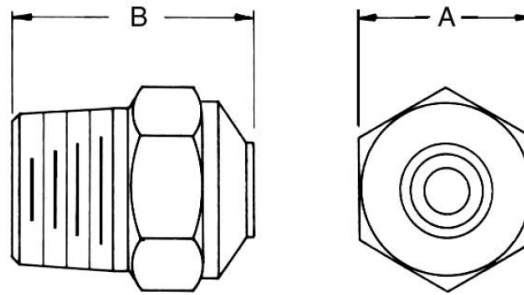

DIMENSIONS & WEIGHTS					
	Material	Inlet			Weight
		Conn. (in.)	A (in.)	B (in.)	Approx.(oz.)
147-00043	Brass	1/4"	5/8"	15/16"	3/4

Nozzle Type	Steinen Part #	RATED CAPACITY (gallons/minute)					Spray Angle (approx.)
		20 PSI	40 PSI	60 PSI	80 PSI	100 PSI	
"S"	147-00043	1.10	1.5	1.80	2.10	2.4	120°