



Solid-Jet[®] Solid Cone Spray

Type **SF**
Type **SM**
Type **SSM**

Steinen Mfg. Co. 29 East Halsey Road, Parsippany, NJ 07054 973.887.6400 F: 973.887.4632 info@steinen.com www.steinen.com

Steinen offers several types of solid (full) cone spray Nozzles. Nozzles are offered in five different body styles, numerous flow rates from 0.12 gallons per minute (GPM) up to 50 GPM, at pressures from 3 PSI to 150 PSI, in various types of steel, stainless steel, brass and CPVC

Three types of nozzle construction are available:

- **Type SF** - three piece removable & internal vane nozzle
- **Type SM** - three piece removable & internal vane nozzle
- **Type SSM** - two piece removable vane nozzle

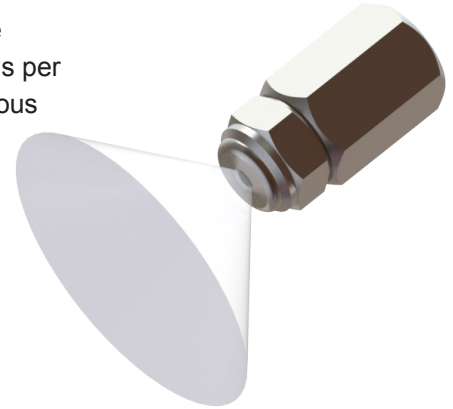

	Spray Characteristics	Construction	Materials
 <p>Type SF</p>	Solid-Jet [®] solid cone type spray with uniform distribution and atomization throughout the entire spray pattern. Atomization finest at higher pressures.	Three-piece design with removable nozzle tip and internal vane possible without disturbing the pipe connection. Nozzles available in 1/8", 1/4", 3/8", 1/2", 3/4" & 1" female NPT pipe thread.	These nozzles are available in 303 & 316 Stainless Steel, steel, brass and CPVC.
 <p>Type SM</p>	Solid-Jet [®] solid cone type spray with uniform distribution and atomization throughout the entire spray pattern. Atomization finest at higher pressures.	Three-piece design with removable nozzle tip and internal vane possible without disturbing the pipe connection. Nozzles available in 1/8", 1/4", 3/8", 1/2", 3/4" & 1" male NPT pipe thread.	These nozzles are available in 303 & 316 Stainless Steel, steel, brass and CPVC.
 <p>Type SSM</p>	Solid-Jet [®] solid cone type spray with uniform distribution and atomization throughout the entire spray pattern. Atomization finest at higher pressures.	Three-piece design with removable nozzle tip and internal vane possible without disturbing the pipe connection. Nozzles available in 1/8", 1/4", 3/8", 1/2", 3/4" & 1" male and female NPT pipe thread.	These nozzles are available in 303 & 316 Stainless Steel, steel, brass and CPVC.



Solid-Jet[®] Solid Cone Spray

Type **SF**
Type **SM**
Type **SSM**

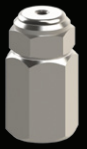

Steinen Mfg. Co. 29 East Halsey Road, Parsippany, NJ 07054 973.887.6400 F: 973.887.4632 info@steinen.com www.steinen.com

Nozzle Identifier	Pipe Size Availability <small>✓ indicates available</small>						Free Passage Size*	Capacity in Gallons Per Minute (At Various Pressures in Pounds Per Square Inch)						SPRAY ANGLE 40 psi
	1/8	1/4	3/8	1/2	3/4	1		10 psi	20 psi	40 psi	80 psi	100 psi	150 psi	
0.2	✓						0.036	—	0.14	0.20	0.28	0.32	0.39	40°
0.4	✓						0.044	0.20	0.28	0.40	0.57	0.63	0.78	50°
0.6	✓						0.044	0.30	0.42	0.60	0.85	0.95	1.2	70°
0.8	✓						0.062	0.40	0.57	0.80	1.1	1.3	1.6	60°
1.0	✓						0.062	0.50	0.71	1.0	1.4	1.6	1.9	70°
1.0		✓					0.078	0.50	0.71	1.0	1.4	1.6	1.9	50°
1.5		✓					0.086	0.75	1.1	1.5	2.1	2.4	2.9	65°
2.0		✓					0.086	1.0	1.4	2.0	2.8	3.2	3.9	75°
2.5		✓					0.086	1.2	1.8	2.5	3.5	3.9	4.8	75°
2.0			✓				0.086	1.0	1.4	2.0	2.8	3.2	3.9	50°
2.5			✓				0.098	1.2	1.8	2.5	3.5	3.9	4.8	60°
3.0			✓				0.098	1.5	2.1	3.0	4.2	4.7	5.8	65°
3.5			✓				0.098	1.1	2.4	3.5	4.9	5.6	6.8	72°
4.0			✓				0.098	2.0	2.8	4.0	5.6	6.3	7.8	83°
4.5			✓				0.098	2.2	3.2	4.5	6.3	7.1	8.7	90°
3.5				✓			0.140	1.7	2.4	3.5	4.9	5.6	6.8	55°
4.0				✓			0.142	2.0	2.8	4.0	5.6	6.3	7.8	58°
4.5				✓			0.142	2.2	3.2	4.5	6.3	7.1	8.7	70°
5.0				✓			0.142	2.4	3.5	5.0	7.1	7.9	9.7	70°
5.5				✓			0.142	2.7	3.8	5.5	7.7	8.6	10.6	75°
6.0				✓			0.142	3.0	4.2	6.0	8.4	9.4	11.6	80°
7.0				✓			0.142	3.5	4.9	7.0	9.9	11.1	13.6	80°
8.0				✓			0.142	4.0	5.7	8.0	11.2	12.7	15.5	90°
6.0					✓		0.187	3.0	4.2	6.0	8.4	9.4	11.6	55°
7.0					✓		0.190	3.5	4.9	7.0	9.9	11.1	13.6	60°
8.0					✓		0.190	4.0	5.7	8.0	11.2	12.7	15.5	65°
9.0					✓		0.190	4.5	6.3	9.0	12.6	14.1	17.4	70°
10.0					✓		0.190	4.9	7.1	10.0	14.2	15.8	19.4	75°
12.0					✓		0.190	6.0	8.5	12.0	17.0	19.0	23.2	80°
14.0					✓		0.190	7.0	9.9	14.0	19.8	22.1	27.0	90°
16.0					✓		0.190	8.0	11.3	16.0	22.6	25.3	31.0	95°
10.0						✓	0.234	5.0	7.1	10.0	14.2	15.8	19.4	55°
12.0						✓	0.244	6.0	8.5	12.0	17.0	19.0	23.2	60°
14.0						✓	0.244	7.0	9.9	14.0	19.8	22.1	27.0	65°
16.0						✓	0.244	8.0	11.3	16.0	22.6	25.3	31.0	70°
18.0						✓	0.244	9.0	12.7	18.0	25.4	28.4	34.8	75°
20.0						✓	0.244	10.0	14.1	20.0	28.2	31.6	38.8	80°
24.0						✓	0.244	12.0	17.0	24.0	34.0	38.0	46.4	95°
26.0						✓	0.244	13.0	18.4	26.0	36.7	41.1	50.5	95°

*Determines maximum foreign particle size that will flow through the nozzle without clogging.

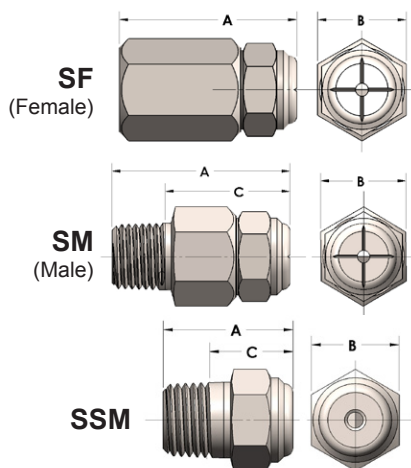

Type	Pipe Size	Net Weight Oz.	A	B	C
SF	1/8 NPT	0.75	1.063	0.563	---
	1/4 NPT	1.25	1.375	0.688	---
	3/8 NPT	2.25	1.563	0.813	---
	1/2 NPT	3.50	1.844	1.000	---
	3/4 NPT	8.00	2.219	1.188	---
	1 NPT	15.00	2.969	1.500	---
SM	1/8 NPT	0.75	1.125	0.563	.825
	1/4 NPT	1.50	1.438	0.688	1.125
	3/8 NPT	2.50	1.563	0.813	1.163
	1/2 NPT	4.00	1.844	1.000	1.300
	3/4 NPT	8.50	2.219	1.125	2.56
	1 NPT	15.75	2.969	1.375	2.062
SSM	1/8 NPT	0.50	0.625	0.500	.325
	1/4 NPT	0.75	0.938	0.625	.538
	3/8 NPT	1.50	0.969	0.750	.569
	1/2 NPT	3.25	1.406	0.875	.906
	3/4 NPT	5.25	1.500	1.125	.960
	1 NPT	12.00	2.375	1.375	1.437