

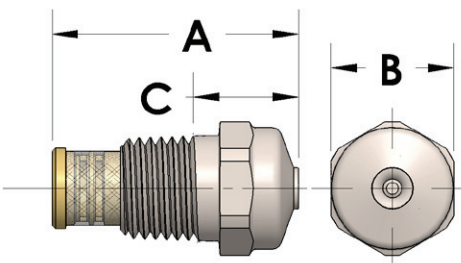

Nozzle Identifier	Approx. Orifice Diameter	Capacity in Gallons per Hour (at various pressures in pounds per square inch)								Spray Angles
		40 psi	60 psi	80 psi	100 psi	125 psi	150 psi	250 psi	500 psi	
0.37	0.009	0.37	0.45	0.52	0.59	0.65	0.72	0.93	1.3	Available in Spray Angles of 70, 80 and 90 degrees.
0.50	0.010	0.50	0.61	0.71	0.79	0.88	0.97	1.3	1.8	
0.75	0.012	0.75	0.92	1.1	1.2	1.3	1.5	1.9	2.7	
1.00	0.014	1.0	1.2	1.4	1.6	1.8	1.9	2.5	3.5	
1.50	0.020	1.5	1.8	2.1	2.4	2.7	2.9	3.8	5.3	
2.00	0.024	2.0	2.4	2.8	3.2	3.5	3.9	5.0	7.1	
2.50	0.028	2.5	3.1	3.5	4.0	4.4	4.8	6.3	8.8	
3.00	0.028	3.0	3.7	4.2	4.7	5.3	5.8	7.5	10.6	
3.50	0.031	3.5	4.3	4.9	5.5	6.2	6.8	8.8	12.4	
4.00	0.036	4.0	4.9	5.7	6.3	7.1	7.7	10.0	14.1	
4.50	0.040	4.5	5.5	6.4	7.1	8.0	8.7	11.3	15.9	
5.00	0.040	5.0	6.1	7.1	7.9	8.8	9.7	12.5	17.7	
5.50	0.040	5.5	6.7	7.8	8.7	9.7	10.7	13.8	19.4	
6.00	0.043	6.0	7.3	8.5	9.5	10.6	11.6	15.0	21.2	
6.50	0.046	6.5	8.0	9.2	10.3	11.5	12.6	16.3	23.0	
7.00	0.046	7.0	8.6	9.9	11.1	12.4	13.6	17.5	24.7	
7.50	0.046	7.5	9.2	10.6	11.9	13.3	14.5	18.8	26.5	
8.00	0.052	8.0	9.8	11.3	12.6	14.1	15.5	20.0	28.3	
8.50	0.052	8.5	10.4	12.0	13.4	15.0	16.5	21.3	30.1	
9.00	0.052	9.0	11.0	12.7	14.2	15.9	17.4	22.5	31.8	
10.0	0.059	10.0	12.2	14.1	15.8	17.7	19.4	25.0	35.4	
12.0	0.063	12.0	14.7	17.0	19.0	21.2	23.2	30.0	42.4	
13.0	0.067	13.0	15.9	18.4	20.6	23.0	25.2	32.5	46.0	
14.0	0.067	14.0	17.1	19.8	22.1	24.7	27.1	35.0	49.5	
15.0	0.070	15.0	18.4	21.2	23.7	26.5	29.0	37.5	53.0	
16.0	0.073	16.0	19.6	22.6	25.3	28.3	31.0	40.0	56.6	
18.0	0.076	18.0	22.0	25.5	28.5	31.8	34.9	45.0	63.6	
20.0	0.076	20.0	24.5	28.3	31.6	35.4	38.7	50.0	70.7	
22.0	0.078	22.0	26.9	31.1	34.8	38.9	42.6	55.0	77.8	
24.0	0.082	24.0	29.4	33.9	37.9	42.4	46.5	60.0	84.9	
26.0	0.082	26.0	31.8	36.8	41.1	46.0	50.3	65.0	91.9	
28.0	0.086	28.0	34.3	39.6	44.3	49.5	54.2	70.0	99.0	
30.0	0.089	30.0	36.7	42.4	47.4	53.0	58.1	75.0	106.1	
35.0	0.096	35.0	42.9	49.5	55.3	61.9	67.8	87.5	123.7	



Type	Pipe Size	Net Weight	A	B	C
P	1/4 NPT	0.75	1.937	0.625	0.500